

VIGAS DA 2ª LAJE(FUNDO DO RESEVATORIO)

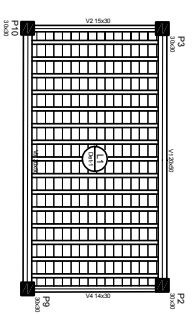

Forma do pavimento laje do fundo d rese

| CARACTERÍSTICAS DA ARMADURA | | | |
|-----------------------------|------------|----------|---------------------|
| TIPO | QUANTIDADE | DIÂMETRO | ESPESURA DO COBRETE |
| REINFORÇO POSITIVO | 10 | 10 | 20 |
| REINFORÇO NEGATIVO | 10 | 10 | 20 |

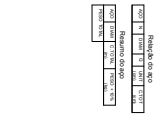
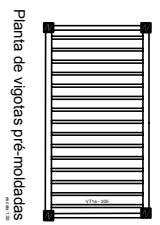
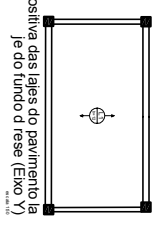
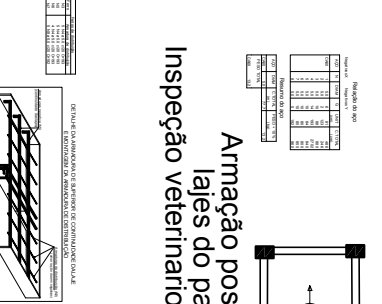
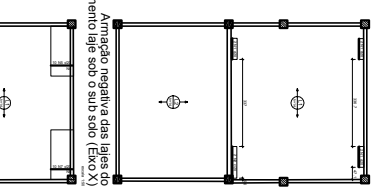

Armação positiva das lajes do pavimento Inspeção veterinario(Eixo X)

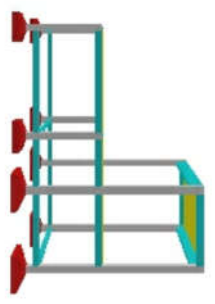
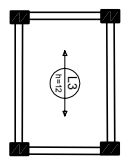

| Resumo do aço | |
|--------------------|------------|
| TIPO | QUANTIDADE |
| REINFORÇO POSITIVO | 10 |
| REINFORÇO NEGATIVO | 10 |

PIARES ATE O NIVEL 6,50(FUNDO DO RESEVATORIO)

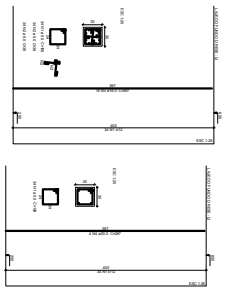

PROPRIETÁRIO: _____

FRANCHA: _____

PROJ. ESTRUTURAL DO CENTRO DE COMERCIALIZAÇÃO

LOCAL: BOA SAÚDE-CENTRO

ASSINATO: _____

VIGORAMENTO: PAREDES LAJE

ESCALAS: INDICADAS

DATA: 02/05/2019

ÁREA CONST: _____

FRANCHA: 02/02

PROJ. JUAN DIEGO

RES. N.º C. _____

Juan Diego

PROJ. CIVIL - 21/08/2019